



TECHNICAL DATA

BLOW MOULDER TYPE		BBM	FD 20E
Clamping force		[kN]	200
CLAMPING UNIT			
Mould length (A) max.		[mm]	650
Mould width (B) max.		[mm]	550
Mould depth (C)		[mm]	2x200
Opening stroke (D)		[mm]	300
PRODUCTION POSSIBILITIES			
Stackable canisters (max. volume)		[litre]	20
EXTRUDER			
RHF		[L/D]	2x 50/30
Drive power		[kW]	2x 29
Output HDPE (max.)		[kg/h]	2x 110
Output HMPE (max.)		[kg/h]	2x 80
DIMENSIONS AND WEIGHTS			
Length		[mm]	3200
Width		[mm]	3000
Height		[mm]	3000
Weight		[to]	15

All data is for information and guidance purposes only. Errors and omissions excepted.

MAIN FEATURES

- Extremely compact single station blow moulder for 10 to 20 l stackable canisters
- Twin extruder technology with new high-output extruders for HMPE
- Extruders allow screw removal to the back
- Coated extrusion heads for best surrounding distribution and quick colour changes
- Automatic electric clamping force adjustment
- Horizontal punching unit and new electric take-out system with flexible article take-out
- BBM „BlowControl 2“ with Multi-Touch Screen with Remote Control
- Proportional control for profiled blow and support air
- 40 – 50 % energy saving compared to hydraulic machines
- Precise movements – right from the first cycle
- Easy access to the production and maintenance area with wide opening safety gates
- Low maintenance costs (no oil, filters, leakages), no cooling energy for hydraulics
- Optional: multi-layer, high-output (ho)-version, post-cooling stations, external punch, IML, view stripe, additional hydraulic system, 2nd neck, quick change features

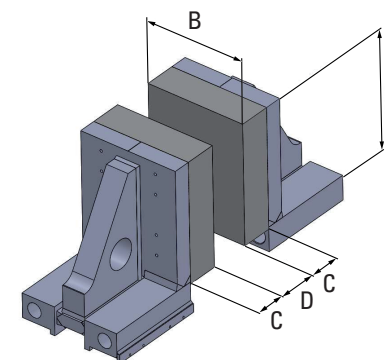

FD 20E

BBM Maschinenbau und Vertriebs GmbH

Dieselstr. 3 - 5
D-33449 Langenberg
Germany

Tel.: +49 (0) 52 48 82 38 - 0
Fax: +49 (0) 52 48 82 38 - 295

E-Mail: sales@bbm-germany.de
Web: www.bbm-germany.de